

4/10 Schild Street Yarraville VIC

2  1  1 

Convenient and modern, this first level unit comprises of a great large open plan living. The lounge room includes a handy study nook, kitchen with stainless steel appliances (including dishwasher) adjoining a private balcony, modern central bathroom including laundry facilities and 2 good sized bedroom both with mirrored built in robes.

Type : Unit

View : <https://www.douglaskay.com.au/lease/vic/west/yarraville/residential/unit/7180473>

This unit also offers a split system, NBN ready and an allocated off street car space with remote gate street access.

Only a short stroll to the delights of Yarraville Village, supermarkets, trendy cafes, restaurants at your doorstep and a convenient lifestyle with low maintenance.

Call Now to Inspect! 03 9313 7888

[For full version visit the website](#)

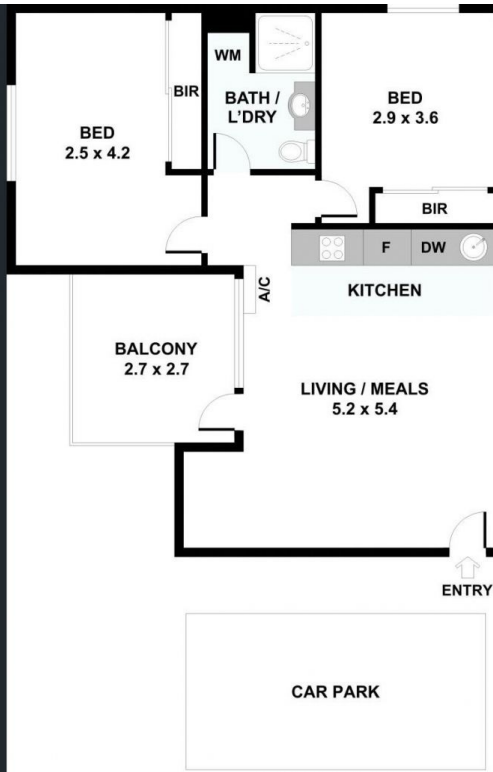

NOT IN CORRECT POSITION