



112/3 Little Boundary Road Laverton North VIC

As new fully self-contained office suite located in a state-of-the-art, innovative commercial and industrial precinct serviced by elevator access.

Located on this high exposure position cornering Princes Hwy and Little Boundary Road, the Brooklyn Interchange boasts prime access to main arterials such as the Westgate freeway, Princes Highway, and the Western Ring Road, as well as easy access to public transport and other local amenities.

Suite 112

- Total area - 64m2 approx
- 1st floor location
- Split system, air-conditioning and heating
- Ample car parking
- Full self contained kitchenette & bathroom/toilet

Price : \$315,000
Building Size : 64 sqm
View : <https://www.douglaskay.com.au/sale/vic/west/laverton-north/commercial/offices/8008296>



Adrian Kay
03 9313 7888

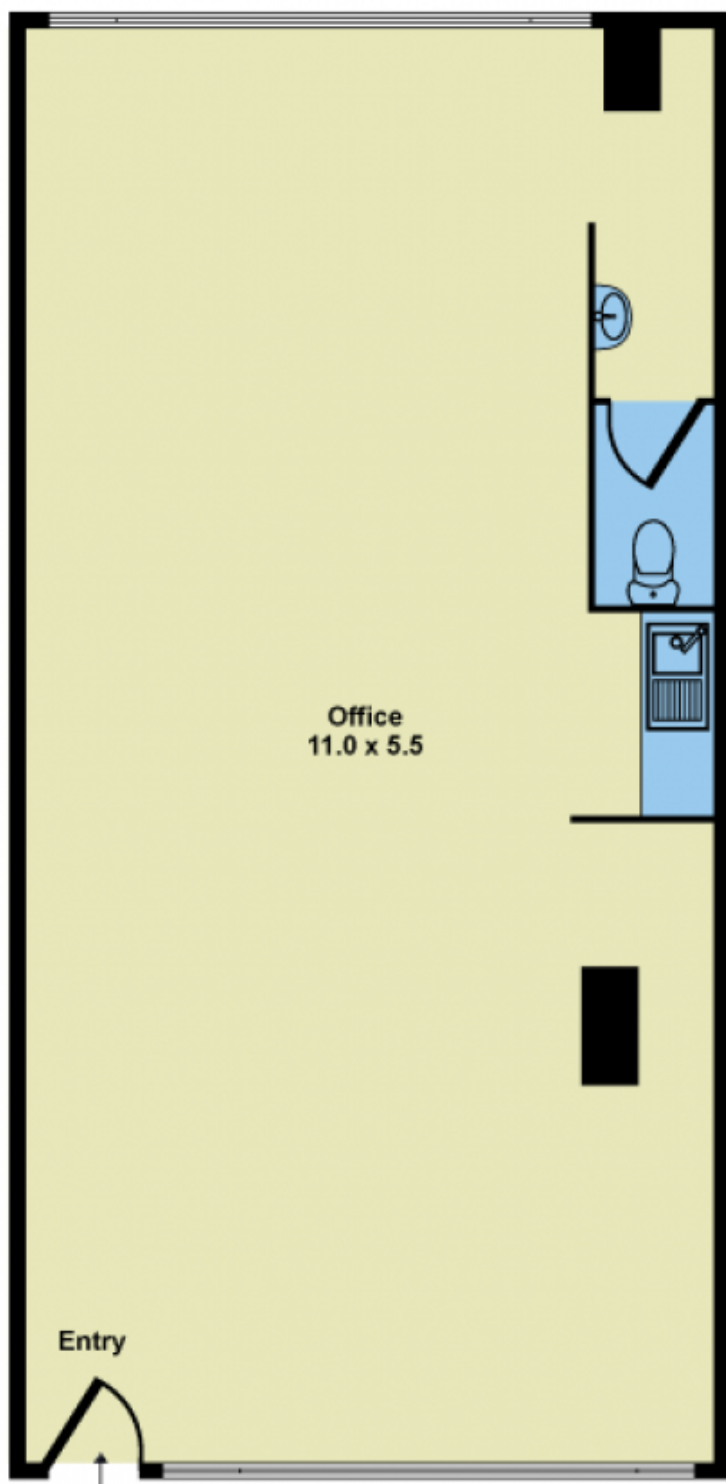

Whilst every attempt has been made to ensure the accuracy of this floorplan, measurements of doors, windows, rooms and any other items are approximates only. The producer or agent cannot be held responsible for any errors, omissions or misstatements. This plan is for illustrative purposes only and should be used as such.