



35 Copernicus Way Keilor Downs VIC

3 2 6

An exceptional opportunity awaits you to own a home of unparalleled construction quality. Nestled within one of suburb's most desirable neighbourhoods.

This locale boasts a rare collection of double-built and tightly held generational homes, exemplifying a commitment to lasting excellence. Don't let this limited opportunity slip through your fingers to acquire a residence in arguably Melbourne's finest family-oriented suburb, offering outstanding value.

As you step inside this impeccably maintained home, you'll be greeted by an abundance of natural light flowing through strategically placed windows in the roomy family area.

Type : House
Price : \$700,000 - \$750,000
Land Size : 650 sqm
View : <https://www.douglaskay.com.au/sale/vic/north-west/keilor-downs/residential/house/8126725>



Peter Kay
03 9313 7888



Adrian Kay
03 9313 7888

[For full version visit the website](https://www.douglaskay.com.au)

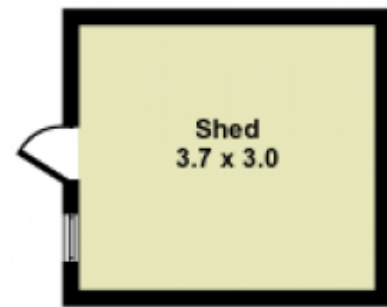

(Not In Position)

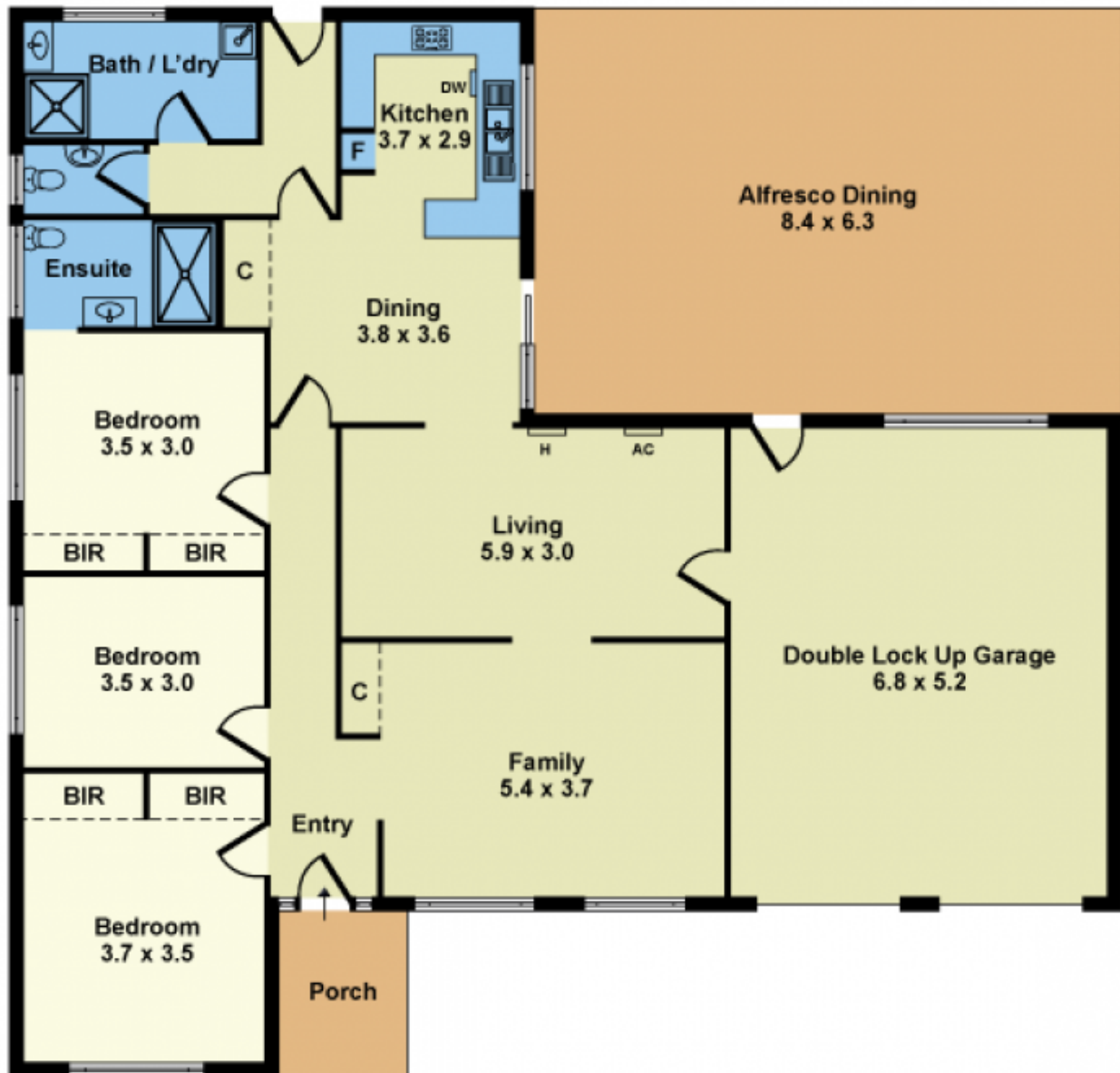

Whilst every attempt has been made to ensure the accuracy of this floorplan, measurements of doors, windows, rooms and any other items are approximates only. The producer or agent cannot be held responsible for any errors, omissions or misstatements. This plan is for illustrative purposes only and should be used as such.